

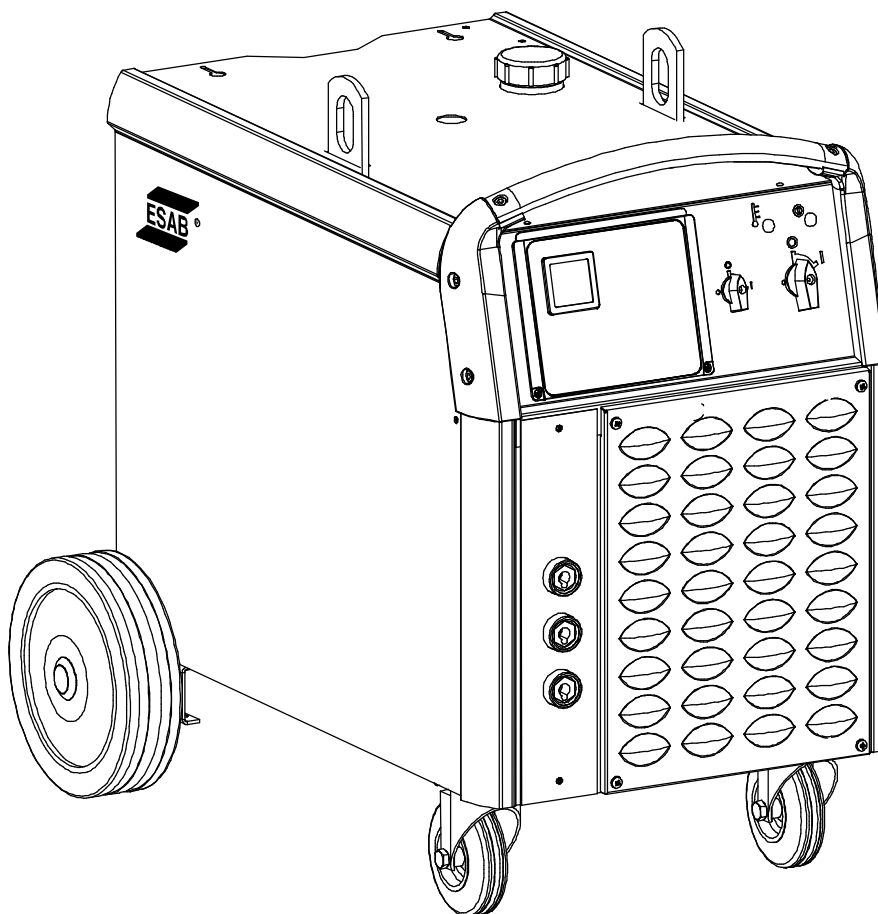

# *Mig 400t*

# *Mig 500t*

*Origo* <sup>TM</sup>



**Instruction manual**

<b>1 DIRECTIVE</b> .....	<b>3</b>
<b>2 SAFETY</b> .....	<b>3</b>
<b>3 INTRODUCTION</b> .....	<b>5</b>
3.1 Equipment .....	5
<b>4 TECHNICAL DATA</b> .....	<b>5</b>
<b>5 INSTALLATION</b> .....	<b>7</b>
5.1 Placing .....	7
5.2 Assembly of components .....	7
5.3 Electrical installation .....	8
5.4 Mains power supply .....	9
<b>6 OPERATION</b> .....	<b>10</b>
6.1 Connections and control devices .....	10
6.2 Overheating protection .....	11
6.3 Water connection .....	11
6.4 Water flow guard .....	11
6.5 Inductance .....	11
<b>7 MAINTENANCE</b> .....	<b>11</b>
7.1 Inspection and cleaning .....	12
7.2 Topping up the coolant .....	12
<b>8 FAULT TRACING</b> .....	<b>12</b>
<b>9 ORDERING OF SPARE PARTS</b> .....	<b>13</b>
<b>DIAGRAM</b> .....	<b>14</b>
<b>ACCESSORIES</b> .....	<b>19</b>

---

## 1 DIRECTIVE

---

### DECLARATION OF CONFORMITY

ESAB AB, Welding Equipment, SE-695 81 Laxå, Sweden, gives its unreserved guarantee that welding power source Origo™ Mig 400t / Origo™ Mig 500t from serial number 627 complies with standard IEC/EN 60974-1, in accordance with the requirements of directive (73/23/EEC) and addendum (93/68/EEC) and with standard IEC/EN 60974-10 in accordance with the requirements of directive (89/336/EEC) and addendum (93/68/EEC).

-----

Laxå 2006-09-05



Kent Eimbrodt  
Global Director Equipment and Automation  
ESAB AB  
695 81 LAXÅ  
SWEDEN

Tel: + 46 584 81000

Fax: + 46 584 411924

---

## 2 SAFETY

---

Users of ESAB welding equipment have the ultimate responsibility for ensuring that anyone who works on or near the equipment observes all the relevant safety precautions. Safety precautions must meet the requirements that apply to this type of welding equipment. The following recommendations should be observed in addition to the standard regulations that apply to the workplace.

All work must be carried out by trained personnel well-acquainted with the operation of the welding equipment. Incorrect operation of the equipment may lead to hazardous situations which can result in injury to the operator and damage to the equipment.

1. Anyone who uses the welding equipment must be familiar with:
  - its operation
  - location of emergency stops
  - its function
  - relevant safety precautions
  - welding
2. The operator must ensure that:
  - no unauthorised person is stationed within the working area of the equipment when it is started up.
  - no-one is unprotected when the arc is struck
3. The workplace must:
  - be suitable for the purpose
  - be free from draughts
4. Personal safety equipment
  - Always wear recommended personal safety equipment, such as safety glasses, flame-proof clothing, safety gloves.
  - Do not wear loose-fitting items, such as scarves, bracelets, rings, etc., which could become trapped or cause burns.
5. General precautions
  - Make sure the return cable is connected securely.
  - Work on high voltage equipment **may only be carried out by a qualified electrician.**
  - Appropriate fire extinguishing equipment must be clearly marked and close at hand.
  - Lubrication and maintenance must **not** be carried out on the equipment during operation.

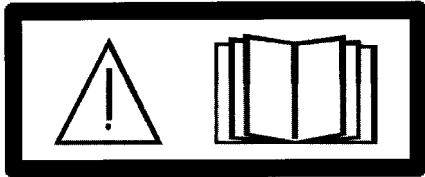

**WARNING!**

Read and understand the instruction manual before installing or operating.



**WARNING**



**ARC WELDING AND CUTTING CAN BE INJURIOUS TO YOURSELF AND OTHERS. TAKE PRECAUTIONS WHEN WELDING. ASK FOR YOUR EMPLOYER'S SAFETY PRACTICES WHICH SHOULD BE BASED ON MANUFACTURERS' HAZARD DATA.**

**ELECTRIC SHOCK - Can kill**

- Install and earth the welding unit in accordance with applicable standards.
- Do not touch live electrical parts or electrodes with bare skin, wet gloves or wet clothing.
- Insulate yourself from earth and the workpiece.
- Ensure your working stance is safe.

**FUMES AND GASES - Can be dangerous to health**

- Keep your head out of the fumes.
- Use ventilation, extraction at the arc, or both, to take fumes and gases away from your breathing zone and the general area.

**ARC RAYS - Can injure eyes and burn skin.**

- Protect your eyes and body. Use the correct welding screen and filter lens and wear protective clothing.
- Protect bystanders with suitable screens or curtains.

**FIRE HAZARD**

- Sparks (spatter) can cause fire. Make sure therefore that there are no inflammable materials nearby.

**NOISE - Excessive noise can damage hearing**

- Protect your ears. Use earmuffs or other hearing protection.
- Warn bystanders of the risk.

**MALFUNCTION - Call for expert assistance in the event of malfunction.**

**READ AND UNDERSTAND THE INSTRUCTION MANUAL BEFORE INSTALLING OR OPERATING.**

**PROTECT YOURSELF AND OTHERS!**

**ESAB can provide you with all necessary welding protection and accessories.**



**WARNING!**

Do not use the power source for thawing frozen pipes.



**This product is solely intended for arc welding.**

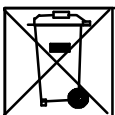

**Do not dispose of electrical equipment together with normal waste!**

In observance of European Directive 2002/96/EC on Waste Electrical and Electronic Equipment and its implementation in accordance with national law, electrical equipment that has reached the end of its life must be collected separately and returned to an environmentally compatible recycling facility. As the owner of the equipment, you should get information on approved collection systems from our local representative.

By applying this European Directive you will improve the environment and human health!

### 3 INTRODUCTION

Origo™ Mig 400t and Origo™ Mig 500t are thyristor power sources designed for MIG/MAG-welding together with wire feed units Origo™ Feed 30x, Origo™ Feed 48x and the most of ESAB wire feeders.

The power sources are fan-cooled and equipped with thermal overload protection.

**ESAB's accessories for the product can be found on page 19.**

#### 3.1 Equipment

The power source is supplied with:

- Return cable 5m with return clamp
- Shelf for gas cylinder
- Attachment chain for gas cylinder
- Guide pin for wire feed unit
- Instruction manual

### 4 TECHNICAL DATA

	Origo™ Mig 400t	Origo™ Mig 500t
<b>Mains voltage</b>	400/415 V 3~ 50 Hz	230/400/415/500 V, 3~ 50 Hz 230/440/460 V, 3~ 60 Hz
<b>Permissible load at</b> 45% duty cycle 60 % duty cycle 100% duty cycle	400 A / 34 V 350 A / 32 V 280 A / 28 V	400 A / 34 V 350 A / 32 V 280 A / 28 V
<b>Setting range (DC)</b>	50A /16.5V-400A /34V	50A/16.5V-400 A/34V
<b>Open circuit voltage</b>	53-58 V	53-58 V
<b>Open circuit power</b> with cooling unit	590 W 790 W	640 W 840 W
<b>Power factor</b> at maximum current	0,86	0,86
<b>Efficiency</b> at maximum current	74 %	76 %
<b>Control voltage</b>	42 V, 50/60 Hz	42 V, 50/60 Hz
<b>Dimensions l x w x h</b>	800 x 640 x 835 mm	800 x 640 x 835 mm
<b>Weight</b> with cooling unit	209 kg 223 kg	210 kg 224 kg
<b>Operating temperature</b>	-10 to +40°C	-10 to +40°C
<b>Enclosure class</b>	IP 23	IP 23
<b>Application classification</b>	<b>S</b>	<b>S</b>

	<b>Origo™ Mig 500t</b>	<b>Origo™ Mig 500t</b>
<b>Mains voltage</b>	400/415 V 3~ 50 Hz	230/400/415/500 V, 3~ 50 Hz 230/440/460 V, 3~ 60 Hz
<b>Permissible load at</b> 60% duty cycle 80 % duty cycle 100% duty cycle	500 A / 39 V 450 A / 37 V 400 A / 34 V	500 A / 39 V 435 A / 36 V 390 A / 33,5 V
<b>Setting range (DC)</b>	50A/16.5V-500A /39V	50A/16.5V-500A /39V
<b>Open circuit voltage</b>	53-60 V	53-60 V
<b>Open circuit power</b> with cooling unit	670 W 870 W	720 W 920 W
<b>Power factor</b> at maximum current	0,90	0,90
<b>Efficiency</b> at maximum current	78 %	78 %
<b>Control voltage</b>	42 V, 50/60 Hz	42 V, 50/60 Hz
<b>Dimensions l x w x h</b>	800 x 640 x 835 mm	800 x 640 x 835 mm
<b>Weight</b> with cooling unit	235 kg 249 kg	237 kg 251 kg
<b>Operating temperature</b>	-10 to +40°C	-10 to +40°C
<b>Enclosure class</b>	IP 23	IP 23
<b>Application classification</b>	<b>S</b>	<b>S</b>

<b>Cooling unit</b>		
Cooling power	2500 W at 40°C temp. difference and flow 1,5l/min	2500 W at 40°C temp. difference and flow 1,5l/min
Coolant	50 % water / 50% glycol	50 % water / 50% glycol
Coolant quantity	5,5 l	5,5 l
Maximum water flow	2,0 l/min	2,0 l/min

### Duty cycle

The duty cycle refers to the time as a percentage of a ten-minute period that you can weld at a certain load without overloading.

### Enclosure class

The **IP** code indicates the enclosure class, i. e. the degree of protection against penetration by solid objects or water. Equipment marked **IP23** is designed for indoor and outdoor use.

### Application class

The symbol **S** indicates that the power source is designed for use in areas with increased electrical hazard.

## 5 INSTALLATION

**The installation must be executed by a professional.**

**Note!**

Connect the power source to the electricity mains with a network impedance of  $0.243\Omega$  (Mig 400tw),  $0.136\Omega$  (Mig 500tw) or lower. If the network impedance is higher, there is a risk of flicker in the illuminators.



**WARNING!**

This product is intended for industrial use. In a domestic environment this product may cause radio interference. It is the user's responsibility to take adequate precautions.

**Lifting instructions**

The power supply should be lifted by means of its lifting eye. The handle is only intended for pulling it along the ground.

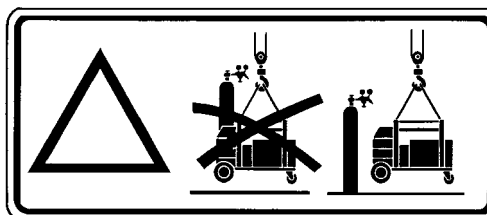

### 5.1 Placing

Position the welding power source such way that its cooling air inlets and outlets are not obstructed.

### 5.2 Assembly of components

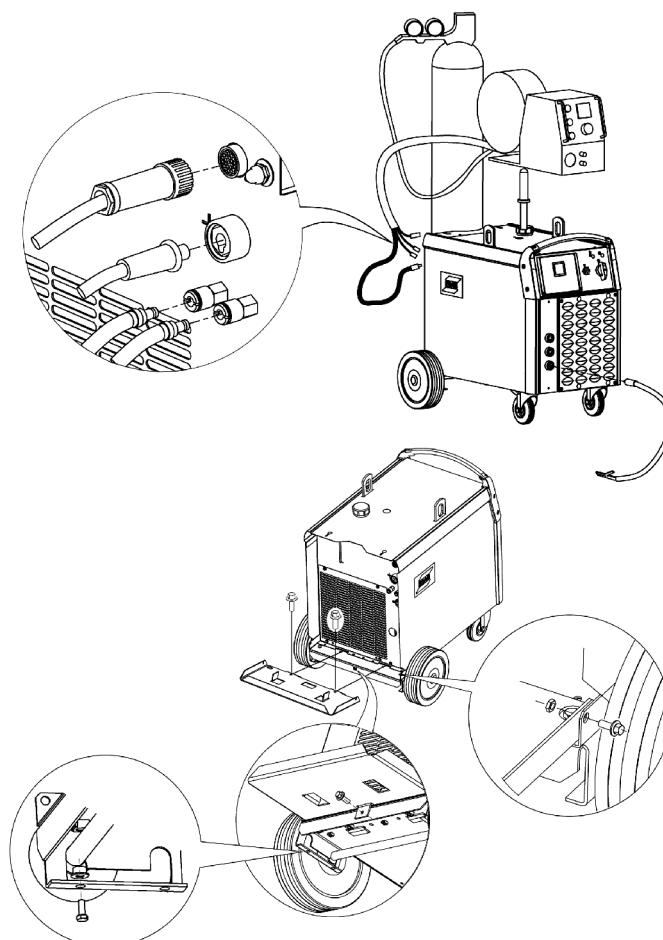



**WARNING!**

During transport, the rear wheels of the power source are in their forward position. Before use, place the wheels in their rear position.

**5.3 Electrical installation**

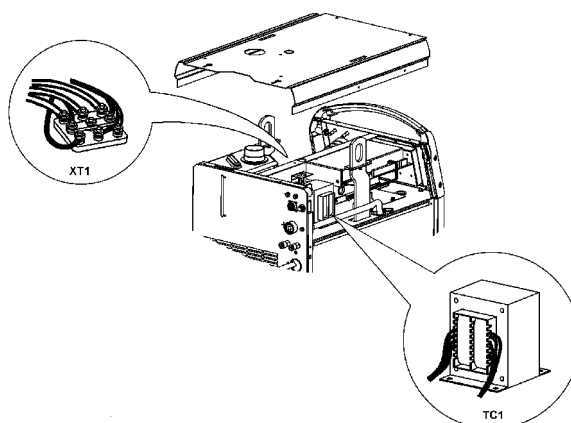
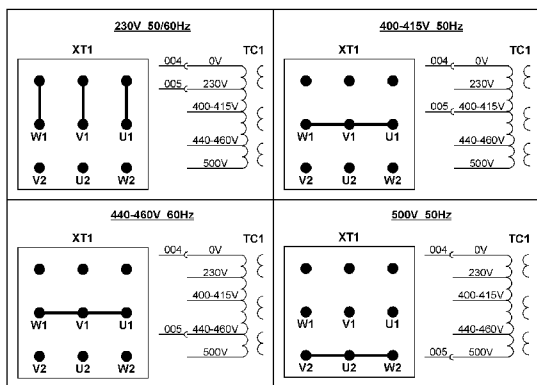
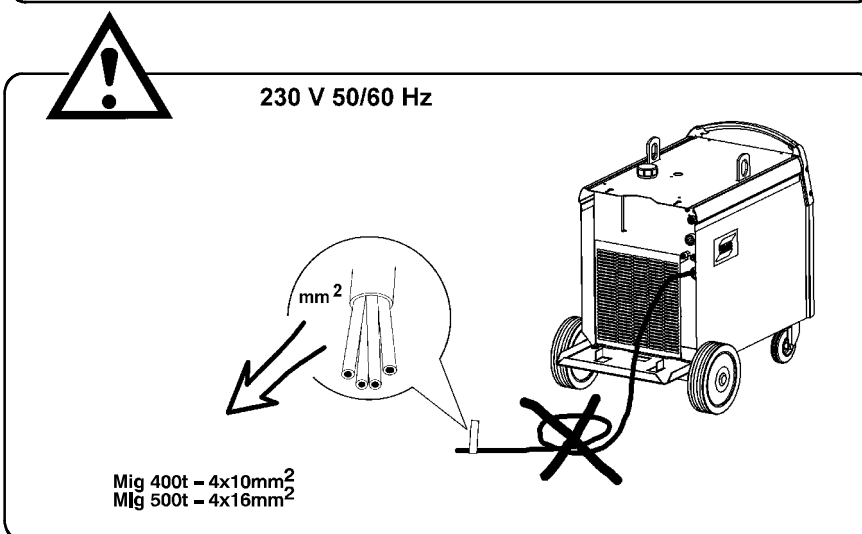
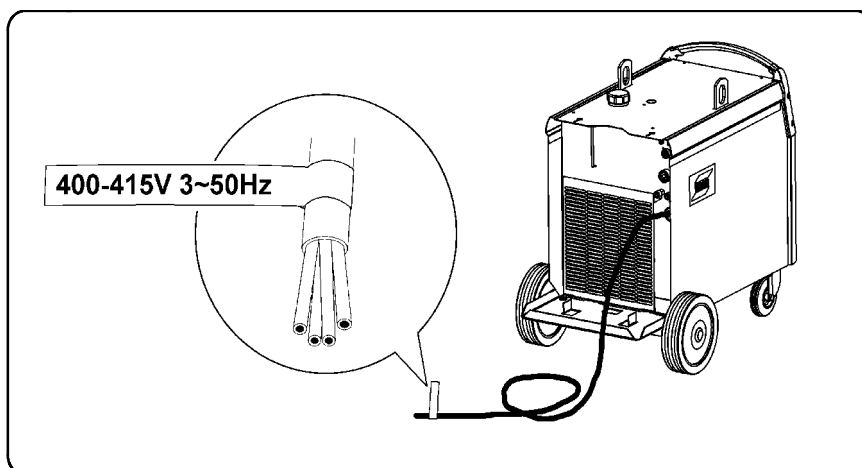



## 5.4 Mains power supply

Check that the unit is connected to the correct mains power supply voltage, and that it is protected by the correct fuse size. A protective earth connection must be made, in accordance with regulations.

*Rating plate with supply connection data*

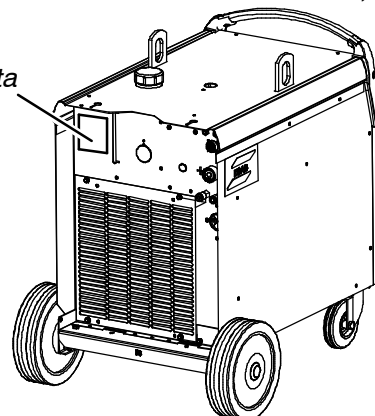

### Recommended fuse sizes and minimum cable areas

Origo™ Mig 400t	3~ 50 Hz	3~ 50 Hz	3~ 50 Hz	3~ 60 Hz	3~ 60 Hz
<b>Mains voltage</b>	230 V	400 / 415 V	500 V	230 V	440 / 460 V
<b>Primary current</b>					
45% duty cycle	51 A	31 A	25 A	51 A	30 A
60% duty cycle	47 A	28 A	22 A	45 A	27 A
100% duty cycle	39 A	23 A	19 A	37 A	22 A
<b>Mains cable area</b>	4x10 mm <sup>2</sup>	4x4 mm <sup>2</sup>	4x4 mm <sup>2</sup>	4x10 mm <sup>2</sup>	4x4 mm <sup>2</sup>
<b>Fuse anti-surge</b>	35 A	25 A	20 A	35 A	20 A

Origo™ Mig 500t	3~ 50 Hz	3~ 50 Hz	3~ 50 Hz	3~ 60 Hz	3~ 60 Hz
<b>Mains voltage</b>	230 V	400 / 415 V	500 V	230 V	440 / 460 V
<b>Primary current</b>					
60% duty cycle	69 A	42 A	33 A	69 A	42 A
80% duty cycle	63 A	38 A	29 A	61 A	37 A
100% duty cycle	59 A	34 A	27 A	56 A	33 A
<b>Mains cable area</b>	4x16 mm <sup>2</sup>	4x6 mm <sup>2</sup>	4x6 mm <sup>2</sup>	4x16 mm <sup>2</sup>	4x6 mm <sup>2</sup>
<b>Fuse anti-surge</b>	63 A	35 A	35 A	50 A	25 A

**NB:** The mains cable areas and fuse sizes as shown above are in accordance with Swedish regulations. They may not be applicable in other countries: make sure that the cable area and fuse sizes comply with the relevant national regulations.

## 6 OPERATION

**General safety regulations for the handling of the equipment can be found on page 3. Read through before you start using the equipment!**



### WARNING - TIPPING RISK!

Fasten the equipment - particularly if the ground is uneven or sloping.

### 6.1 Connections and control devices

- |   |  |    |  |
|---|--|----|--|
| 1 | Connection for control cable to the wire feed unit       | 8  | Connection for return cable (-), low inductance          |
| 2 | MCB  | 9  | Connection for return cable (-), medium inductance       |
| 3 | Display (digital meters) is an accessory see on page 19. | 10 | Connection for return cable (-), high inductance         |
| 4 | Orange indicating lamp, overheating and loss of coolant* | 11 | Connection RED for cooling water from the wire feed unit |
| 5 | White indicating lamp, power supply ON                   | 12 | Connection BLUE for cooling water to the wire feed unit  |
| 6 | Main supply switch                                       | 13 | Connection for welding current cable (+)                 |
| 7 | Main supply switch for cooling unit ELP**                |    |  |

**NOTE!** Cooling water connections only available on certain models.

\* Indicating loss of coolant, only when water flow guard is used, see point 6.4

\*\* ELP = ESAB Logic Pump, see point 6.3.

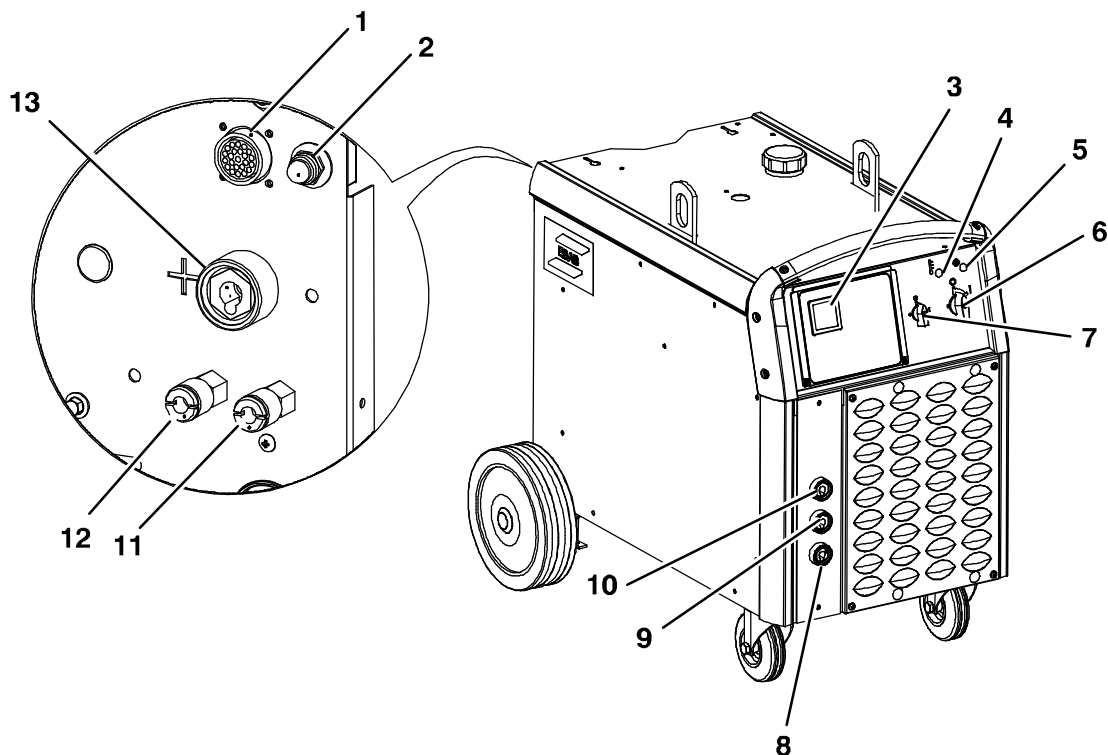

## 6.2 Overheating protection

The power source has one thermal overload trip which operates if the internal temperature becomes too high, interrupting the welding current and lighting the orange indicating lamp on the front of the unit. It resets automatically when the temperature has fallen and the indicating lamp will go out.

## 6.3 Water connection

The Origo™ Feed has a sensor **ELP, ESAB Logic Pump**, that senses if the water hoses of the welding gun are connected. When a water cooled welding gun is connected, the water pump starts.

When using other wire feed units, the water pump switch must be in position "I" when a water cooled welding gun is used.

When connecting the cooling water hoses to/from the Feed wire feed unit, the mains ON/OFF switch of the Origo™ Mig must be in the OFF position.

When a self cooled welding gun is used the pump switch must be in position "ELP/0".

**Note**, if a water cooled welding gun is used when the pump is inactive, the welding gun might be damaged.

## 6.4 Water flow guard

The water flow guard interrupts the welding current in the event of loss of coolant and an orange indicating lamp on the front of the power source lights up.

The water flow guard is an accessory. Ordering number see on page 20.

## 6.5 Inductance

Higher inductance produces a more flowing weld and less spatter. Lower inductance produces a harsher sound and a stable, concentrated arc.

---

# 7 MAINTENANCE

---

*Regular maintenance is important for safe, reliable operation.*

*Maintenance must be executed by a professional.*

*Only those persons who have appropriate electrical knowledge (authorised personnel) may remove the safety plates.*

### **Note!**

*All guarantee undertakings from the supplier cease to apply if the customer himself attempts any work in the product during the guarantee period in order to rectify any faults.*

## 7.1 Inspection and cleaning

Check regularly that the power source is free from dirt.

The power source should be regularly blown clean using dry compressed air at reduced pressure. More frequently in dirty environments.

Otherwise the air inlet/outlet may become blocked and cause overheating. To avoid this you can use an airfilter.

The airfilter is an accessory. Ordering number on page 20.

## 7.2 Topping up the coolant

We recommend a 50/50 % mixture of water and ethylene glycol.

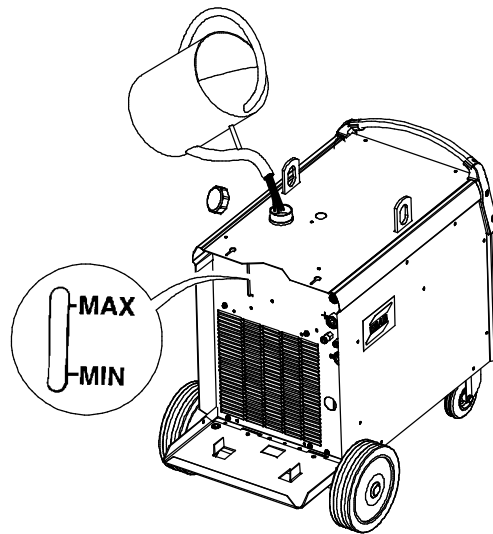

## 8 FAULT TRACING

*Try these recommended checks and inspections before sending for an authorised service technician.*

Type of fault	Actions
No arc.	<ul style="list-style-type: none"> <li>• Check that the mains power supply switch is turned on.</li> <li>• Check that the welding current supply and return cables are correctly connected.</li> <li>• Check that the correct current value is set.</li> <li>• Check to see whether the MCB has tripped.</li> </ul>
Welding current is interrupted during welding	<ul style="list-style-type: none"> <li>• Check whether the thermal overload trip has operated (indicated by the orange lamp on the front)</li> <li>• Check the main power supply fuses.</li> </ul>
The thermal overload trips operate frequently	<ul style="list-style-type: none"> <li>• Check to see whether the air filters are clogged.</li> <li>• Make sure that you are not exceeding the rated data for the power source (i.e. that the unit is not being overloaded).</li> </ul>
Poor welding performance.	<ul style="list-style-type: none"> <li>• Check that the welding current supply and return cables are correctly connected.</li> <li>• Check that the correct current value is set.</li> <li>• Check that the correct welding wires are being used.</li> <li>• Check the main power supply fuses.</li> </ul>

---

**9 ORDERING OF SPARE PARTS**

---

**Origo™ Mig 400t / Origo™ Mig 500t is designed and tested in accordance with the international and European standards IEC/EN 60974-1 and EN 60974-10. It is the obligation of the service unit which has carried out the service or repair work to make sure that the product still conforms to the said standard.**

Spare parts may be ordered through your nearest ESAB dealer, see the last page of this publication.

# Diagram

400 - 415 V

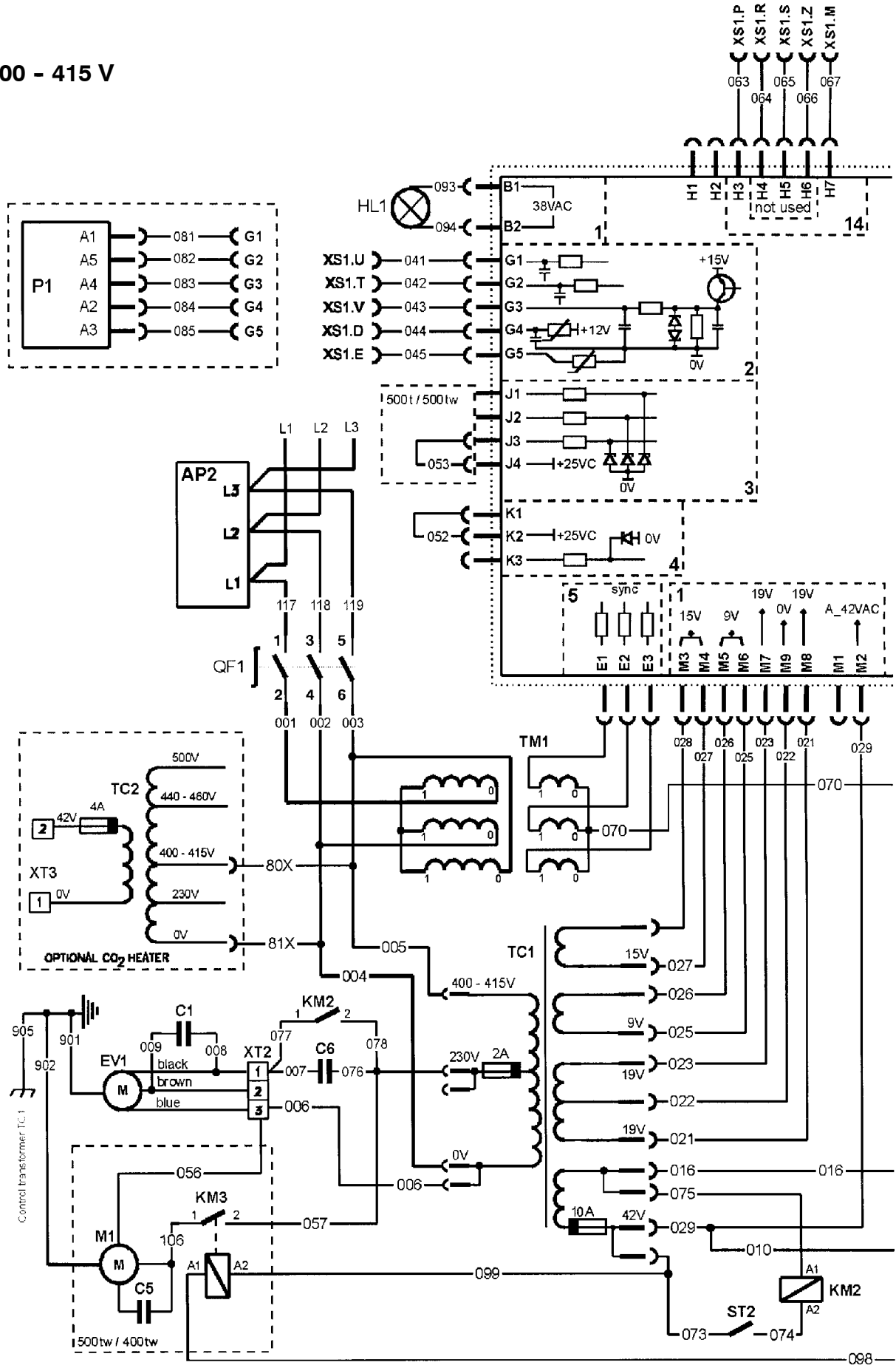



230 - 500V

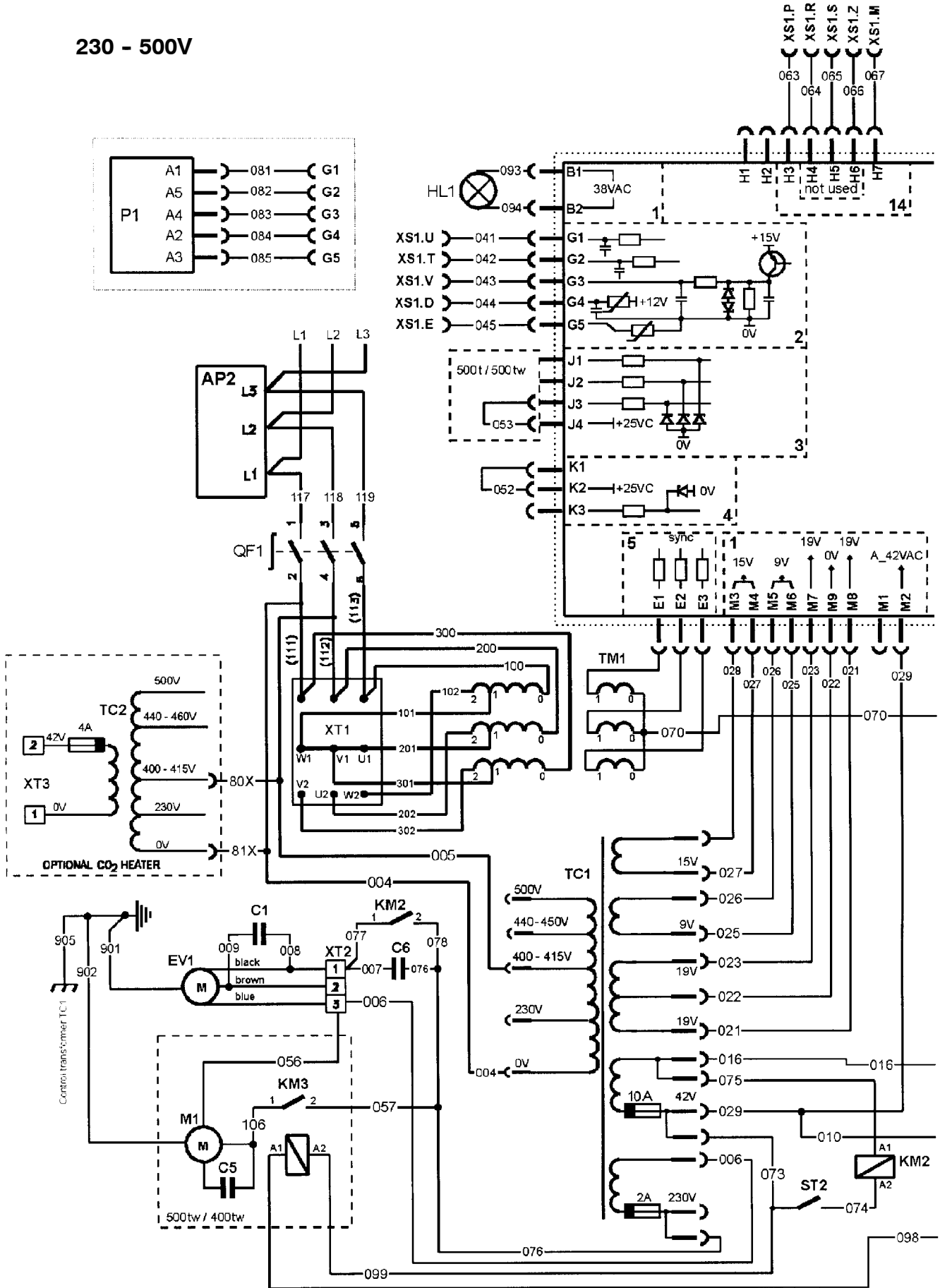



230 - 500V

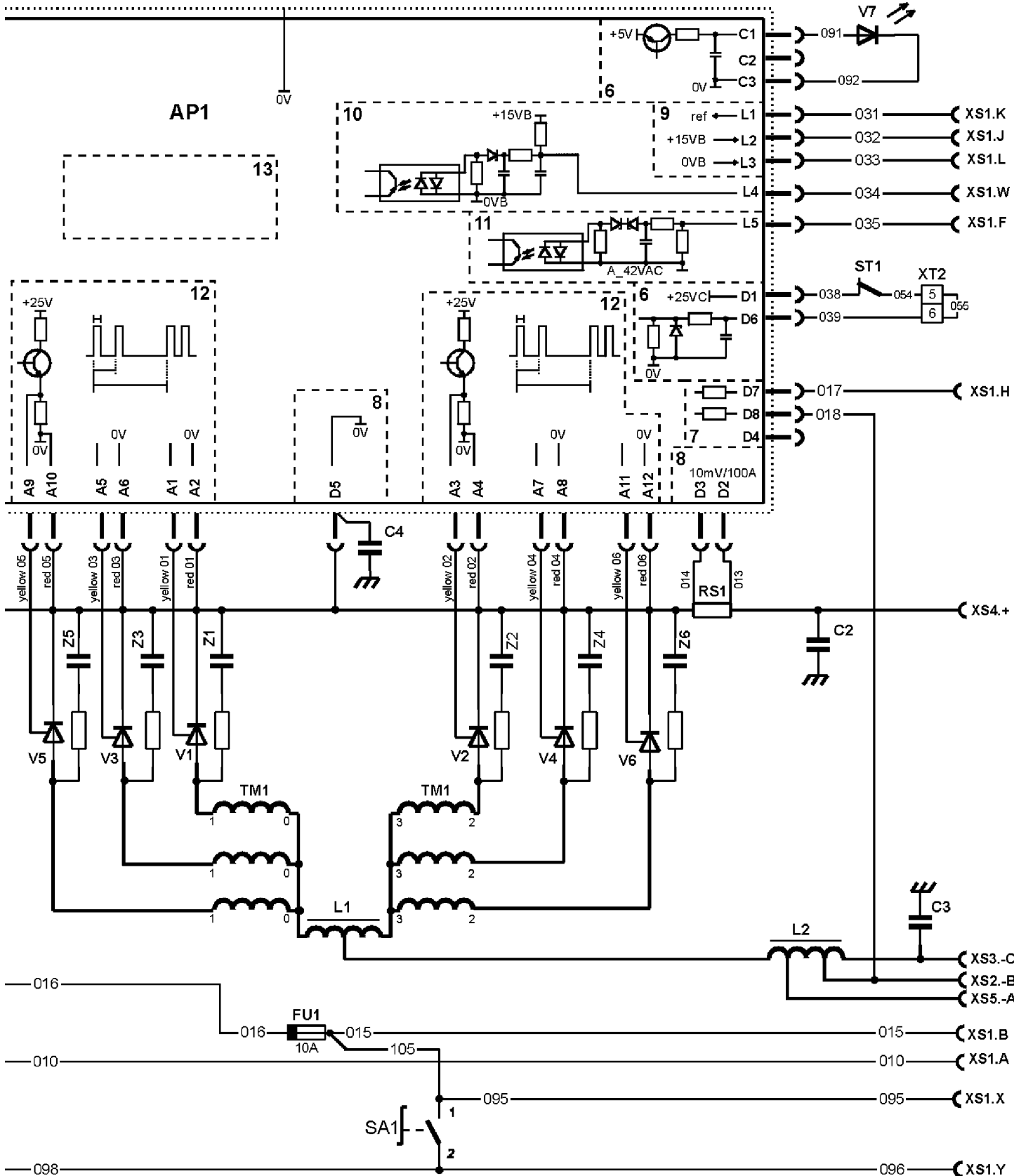
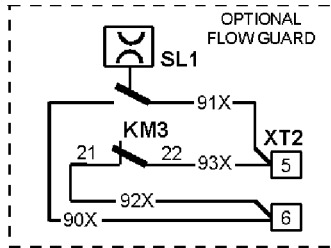

## Origo™ Mig 400t / Origo™ Mig 500t

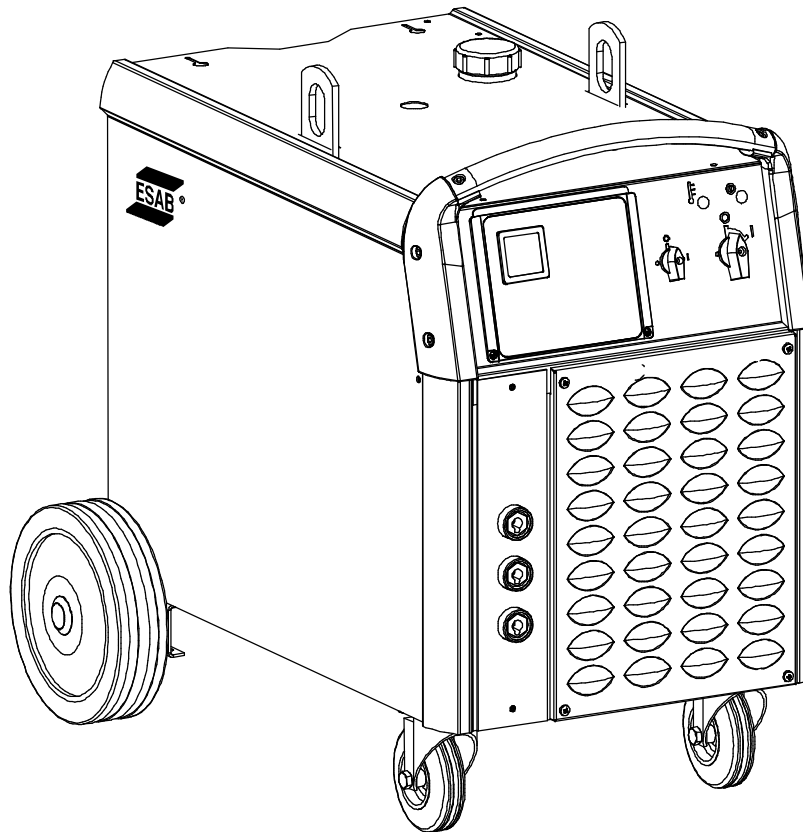

Valid for serial no. 627-XXX-XXXX

### Ordering numbers

0349 302 242	Origo™ Mig 400t	400V / 415V, 3~50Hz
0349 302 243	Origo™ Mig 400t	230V / 400V / 415V / 500V 3~50Hz, 230V / 440V / 460V 3~60Hz
0349 302 244	Origo™ Mig 400tw	400V / 415V, 3~50Hz; with water cooler
0349 302 245	Origo™ Mig 400tw	230V / 400V / 415V / 500V 3~50Hz, 230V / 440V / 460V 3~60Hz; with water cooler
0349 302 246	Origo™ Mig 500t	400V / 415V, 3~50Hz
0349 302 247	Origo™ Mig 500t	230V / 400V / 415V / 500V 3~50Hz, 230V / 440V / 460V 3~60Hz
0349 302 248	Origo™ Mig 500tw	400V / 415V, 3~50Hz; with water cooler
0349 302 249	Origo™ Mig 500tw	230V / 400V / 415V / 500V 3~50Hz, 230V / 440V / 460V 3~60Hz; with water cooler
0349 303 728	Origo™ Mig 500tw	400V / 415V, 3~50Hz; with water cooler, with circuit breaker

Accessories

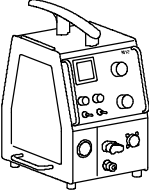
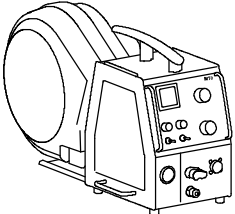
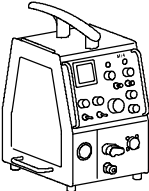
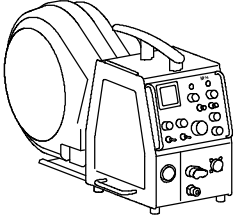
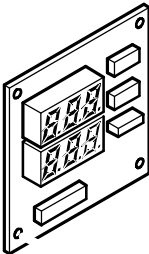
	<p><b>Origo™ Feed for Marathon Pac™, M13 panel</b> 0459 114 883</p> <p>Origo™ Feed 304 M13 ..... 0459 114 884</p> <p>Origo™ Feed 304 M13 with display ..... 0459 114 893</p> <p>Origo™ Feed 304 M13 with water ..... 0459 114 894</p> <p>Origo™ Feed 304 M13 with display and water ..... 0459 114 983</p> <p>Origo™ Feed 484 M13 ..... 0459 114 984</p> <p>Origo™ Feed 484 M13 with display ..... 0459 114 993</p> <p>Origo™ Feed 484 M13 with water ..... 0459 114 994</p> <p>Origo™ Feed 484 M13 with display and water</p>
	<p><b>Origo™ Feed with capsulated bobbin, M13 panel</b> 0459 116 883</p> <p>Origo™ Feed 304 M13 ..... 0459 116 884</p> <p>Origo™ Feed 304 M13 with display ..... 0459 116 893</p> <p>Origo™ Feed 304 M13 with water ..... 0459 116 894</p> <p>Origo™ Feed 304 M13 with display and water ..... 0459 116 983</p> <p>Origo™ Feed 484 M13 ..... 0459 116 984</p> <p>Origo™ Feed 484 M13 with display ..... 0459 116 993</p> <p>Origo™ Feed 484 M13 with water ..... 0459 116 994</p> <p>Origo™ Feed 484 M13 with display and water</p>
	<p><b>Origo™ Feed for Marathon Pac™, M14 panel</b> 0459 114 895</p> <p>Origo™ Feed 304 M13 with display and water ..... 0459 114 995</p> <p>Origo™ Feed 484 M13 with display and water</p>
	<p><b>Origo™ Feed with capsulated bobbin, M14 panel</b> ... 0459 116 895</p> <p>Origo™ Feed 304 M13 with display and water ..... 0459 116 995</p> <p>Origo™ Feed 484 M13 with display and water</p>
	<p><b>Digital instrument</b> ..... 0455 173 882</p>

**Transformer for CO<sub>2</sub> heater ..... 0349 302 250**

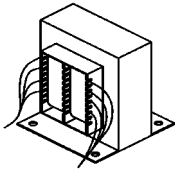

**Guide pin ..... 0349 302 303**

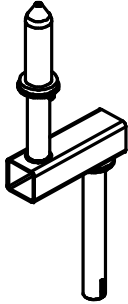

**Water flow guard ..... 0349 302 251**

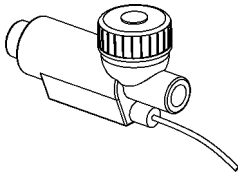

**Filter ..... 0349 302 252**

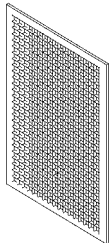

**Holder for welding gun and cables ..... 0349 303 362**

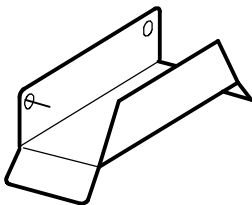

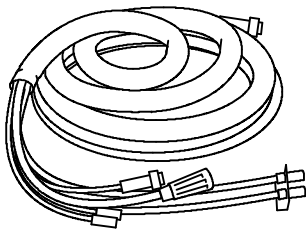

**Connection set for 400 A power sources**

Connection set 1.7 m .....	0469 836 880
Connection set 10 m .....	0469 836 881
Connection set 15 m .....	0469 836 882
Connection set 25 m .....	0469 836 883
Connection set 35 m .....	0469 836 884
Connection set 1.7 m, water .....	0469 836 885
Connection set 10 m, water .....	0469 836 886
Connection set 15 m, water .....	0469 836 887
Connection set 25 m, water .....	0469 836 888
Connection set 35 m, water .....	0469 836 889

**Connection set for 500 A power sources**

Connection set 1.7 m .....	0469 836 890
Connection set 10 m .....	0469 836 891
Connection set 15 m .....	0469 836 892
Connection set 25 m .....	0469 836 893
Connection set 35 m .....	0469 836 894
Connection set 1.7 m, water .....	0469 836 895
Connection set 10 m, water .....	0469 836 896
Connection set 15 m, water .....	0469 836 897
Connection set 25 m, water .....	0469 836 898
Connection set 35 m, water .....	0469 836 899

For more information of the accessories contact the nearest ESAB agency.

# ESAB subsidiaries and representative offices

## Europe

### AUSTRIA

ESAB Ges.m.b.H  
Vienna-Liesing  
Tel: +43 1 888 25 11  
Fax: +43 1 888 25 11 85

### BELGIUM

S.A. ESAB N.V.  
Brussels  
Tel: +32 2 745 11 00  
Fax: +32 2 745 11 28

### THE CZECH REPUBLIC

ESAB VAMBERK s.r.o.  
Vamberk  
Tel: +420 2 819 40 885  
Fax: +420 2 819 40 120

### DENMARK

Aktieselskabet ESAB  
Herlev  
Tel: +45 36 30 01 11  
Fax: +45 36 30 40 03

### FINLAND

ESAB Oy  
Helsinki  
Tel: +358 9 547 761  
Fax: +358 9 547 77 71

### FRANCE

ESAB France S.A.  
Cergy Pontoise  
Tel: +33 1 30 75 55 00  
Fax: +33 1 30 75 55 24

### GERMANY

ESAB GmbH  
Solingen  
Tel: +49 212 298 0  
Fax: +49 212 298 218

### GREAT BRITAIN

ESAB Group (UK) Ltd  
Waltham Cross  
Tel: +44 1992 76 85 15  
Fax: +44 1992 71 58 03

ESAB Automation Ltd

Andover  
Tel: +44 1264 33 22 33  
Fax: +44 1264 33 20 74

### HUNGARY

ESAB Kft  
Budapest  
Tel: +36 1 20 44 182  
Fax: +36 1 20 44 186

### ITALY

ESAB Saldatura S.p.A.  
Mesero (Mi)  
Tel: +39 02 97 96 81  
Fax: +39 02 97 28 91 81

### THE NETHERLANDS

ESAB Nederland B.V.  
Utrecht  
Tel: +31 30 2485 377  
Fax: +31 30 2485 260

## NORWAY

AS ESAB  
Larvik  
Tel: +47 33 12 10 00  
Fax: +47 33 11 52 03

## POLAND

ESAB Sp.zo.o.  
Katowice  
Tel: +48 32 351 11 00  
Fax: +48 32 351 11 20

## PORTUGAL

ESAB Lda  
Lisbon  
Tel: +351 8 310 960  
Fax: +351 1 859 1277

## SLOVAKIA

ESAB Slovakia s.r.o.  
Bratislava  
Tel: +421 7 44 88 24 26  
Fax: +421 7 44 88 87 41

## SPAIN

ESAB Ibérica S.A.  
Alcalá de Henares (MADRID)  
Tel: +34 91 878 3600  
Fax: +34 91 802 3461

## SWEDEN

ESAB Sverige AB  
Gothenburg  
Tel: +46 31 50 95 00  
Fax: +46 31 50 92 22

ESAB international AB

Gothenburg  
Tel: +46 31 50 90 00  
Fax: +46 31 50 93 60

## SWITZERLAND

ESAB AG  
Dietikon  
Tel: +41 1 741 25 25  
Fax: +41 1 740 30 55

## North and South America

### ARGENTINA

CONARCO  
Buenos Aires  
Tel: +54 11 4 753 4039  
Fax: +54 11 4 753 6313

### BRAZIL

ESAB S.A.  
Contagem-MG  
Tel: +55 31 2191 4333  
Fax: +55 31 2191 4440

### CANADA

ESAB Group Canada Inc.  
Mississauga, Ontario  
Tel: +1 905 670 02 20  
Fax: +1 905 670 48 79

### MEXICO

ESAB Mexico S.A.  
Monterrey  
Tel: +52 8 350 5959  
Fax: +52 8 350 7554

### USA

ESAB Welding & Cutting Products  
Florence, SC  
Tel: +1 843 669 44 11  
Fax: +1 843 664 57 48

## Asia/Pacific

### CHINA

Shanghai ESAB A/P  
Shanghai  
Tel: +86 21 5308 9922  
Fax: +86 21 6566 6622

### INDIA

ESAB India Ltd  
Calcutta  
Tel: +91 33 478 45 17  
Fax: +91 33 468 18 80

### INDONESIA

P.T. ESABindo Pratama  
Jakarta  
Tel: +62 21 460 0188  
Fax: +62 21 461 2929

### JAPAN

ESAB Japan  
Tokyo  
Tel: +81 3 5296 7371  
Fax: +81 3 5296 8080

### MALAYSIA

ESAB (Malaysia) Snd Bhd  
Selangor  
Tel: +60 3 8027 9869  
Fax: +60 3 8027 4754

### SINGAPORE

ESAB Asia/Pacific Pte Ltd  
Singapore  
Tel: +65 6861 43 22  
Fax: +65 6861 31 95

### SOUTH KOREA

ESAB SeAH Corporation  
Kyungnam  
Tel: +82 55 269 8170  
Fax: +82 55 289 8864

### UNITED ARAB EMIRATES

ESAB Middle East FZE  
Dubai  
Tel: +971 4 887 21 11  
Fax: +971 4 887 22 63

## Representative offices

### BULGARIA

ESAB Representative Office  
Sofia  
Tel/Fax: +359 2 974 42 88

### EGYPT

ESAB Egypt  
Dokki-Cairo  
Tel: +20 2 390 96 69  
Fax: +20 2 393 32 13

### ROMANIA

ESAB Representative Office  
Bucharest  
Tel/Fax: +40 1 322 36 74

### RUSSIA

LLC ESAB  
Moscow  
Tel: +7 095 543 9281  
Fax: +7 095 543 9280

LLC ESAB

St Petersburg  
Tel: +7 812 336 7080  
Fax: +7 812 336 7060

## Distributors

*For addresses and phone numbers to our distributors in other countries, please visit our home page*

[www.esab.com](http://www.esab.com)



ESAB AB  
SE-695 81 LAXÅ  
SWEDEN  
Phone +46 584 81 000

[www.esab.com](http://www.esab.com)

